



# *The clarinet, the founding instrument*

The clarinet was the first instrument developed by Henri SELMER, renowned clarinetist at the Orchestre de la Garde Républicaine and the Opéra Comique.

The enduring spirit of innovation and the closeness to clarinetists around the world are reflected daily in the design of the instruments, which are made with the musicians and for the musicians.

Located in Mantes-la-Ville (France) for over a century, today our workshops are the only factory in the world with the know-how to manufacture the entire clarinet family.



Designer and manufacturer of wind instruments since 1885

[selmer.fr](http://selmer.fr)





Bb & A  
CLARINETS

# *Be inspired... by Muse*

We are presenting you with this new instrument for playing with great ease.

Designed to become the natural extension of your breath, each note has clarity, immediate vibration and guaranteed reliability via the EVOLUTION★ system.

For four years, the Henri SELMER Paris development team and orchestra clarinet players from different countries, brought together for this project, have been combining their knowledge and experience to produce the Muse set of professional clarinets.

With optimised ergonomics, tone rich in harmonics and well calibrated intonation with precise intervals, Muse clarinets were designed to become both tools and accomplices for clarinet players. They benefit from the excellent manufacturing quality of Henri SELMER Paris clarinets, carefully selected woods and an outstanding reliability thanks to the EVOLUTION★ system (increased stability and longevity).

The refined aesthetics of these clarinets add to the pleasure of playing them and aim to inspire clarinetists of all generations and musical styles, both amateurs and professionals.

**Thanks to Muse, free your artistic potential and inspire... the world!**



## *They play the Muse clarinets*

Maura Marinucci, François Sauzeau, Florent Pujaila, Wesley Ferreira,  
Myriam Carrier, Mariam Adam, Sylvie Hue, Philippe Berrod...

Learn more about our Muse ambassadors on [selmer.fr](http://selmer.fr)

# Conception and Inspiration

Pursuing the successful dynamic of the new generation of clarinets (Privilège, Présence and Prologue), the Bb and A Muse clarinets have been designed for clarinetists seeking instruments offering a very precise and direct response.

The Muse clarinets evoke the artists' source of inspiration to lead them to creative freedom, beauty, universal harmony.

## Aesthetics

The original laser engraving on the bottom body of the instrument (*see detail below*), is inspired by the values of generosity, listening and transmission of the musical practice.

To complete their aesthetics, the Muse clarinets have two flat black chrome-plated metal rings, as well as two silver-plated rings with a new design.

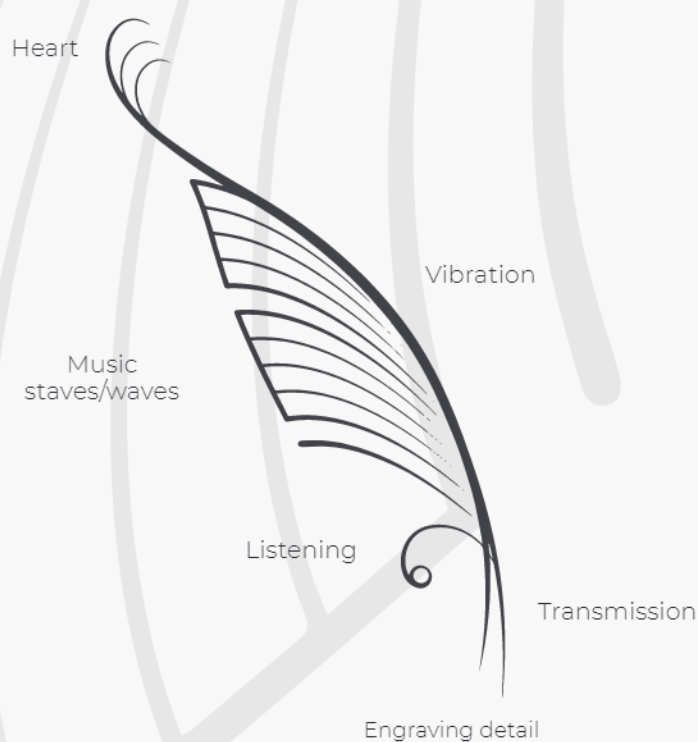

The feather, a symbol of lightness and creative freedom



New ring design



# Muse

Bb & A clarinets

## Ergonomics

- Ergonomic comfort similar to the one on our Privilège and Présence models, tested by numerous clarinetists worldwide
- Adjustable thumb key for low F and E correction on the A clarinet, also available on the Bb clarinet.



## Acoustics

- New conical bores for both 64 and 65mm barrels
- New conical bores of the body
- G# C# precision optimized by a raised tone hole
- New geometry of the holes
- New bell bores



## Correction of tone

The A clarinet benefit from a correction of tone



Adjustable thumb key

## Selected woods



- Specially selected granadilla wood, stabilized for three years in a controlled environment, at constant temperature and hygrometry.
- 100% natural wax



7mm metal rings

*J. Selmer*

## Mechanics and Materials



- Resin interior lining on the EVOLUTION★ system upper joint
- Adjusting screw for the C lever
- Upper joint fitted together with the crimped metal lower joint
- 4 and 7mm metal rings
- Black chrome-plated metal bell ring
- Efficient sealing: leather pads fitted with resonators for the low notes (except Eb), Gore-Tex pads on the upper joint and cork pads for the 12<sup>th</sup> key

4mm metal ring



for the C lever

## Correction system for low F and E notes

with a correction key of low F and E notes, also available on the Bb clarinet.



Correction system for low F and E notes with adjusting screw



Correction tone hole for low E on the lower joint!

# Embedded EVOLUTION★ system

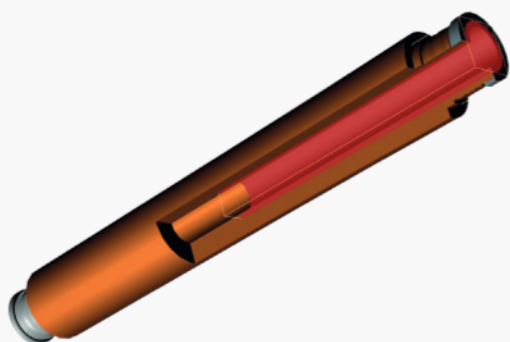

This innovation based on a new generation resin **interior lining**, providing better stability and longevity to the instrument, while preserving the acoustic qualities of a traditional wooden clarinet.

Scientific studies along with blind acoustic tests demonstrated that there is no notable difference in sound between traditional clarinets and EVOLUTION★ system clarinets.

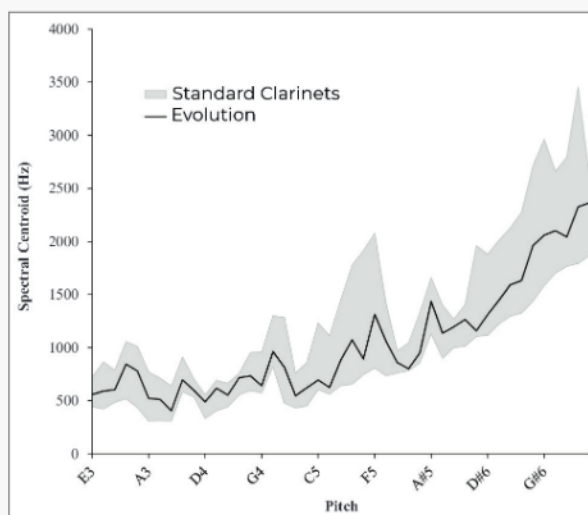

The manufacturing process combined with the waterproof characteristics of the material creates a hermetic envelope preventing the infiltration of moisture into the wood fibers. Henri SELMER Paris solves the problem of cracks in the most sensitive part of the instrument.

Henri SELMER Paris offers a **10-year warranty** on all upper joints of clarinets made with the EVOLUTION★ system.

## Accessories



PRiSMe  
single  
or double  
case



Echo is a universal mouthpiece suitable for all clarinetists and the first Henri SELMER Paris clarinet mouthpiece to be entirely manufactured on a digitally controlled machine, giving it an unprecedented production stability.



Inspirational Notebook  
(160 pages)



swab



cork grease



silver-plated  
ligature and cap



soft cloth